

1 MAIN MENU

The Main Menu has three icons. Charge, History and Settings. Select the Charge Icon to Proceed.

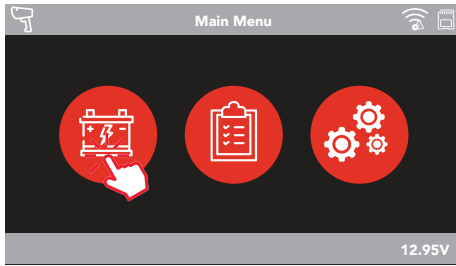

2 SELECT CHARGING MODE

Select ECU Reflash Mode.

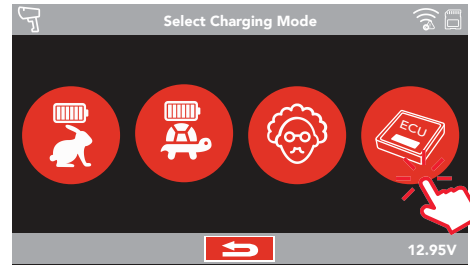

3 WARNING

Warning screen displays before test starts.

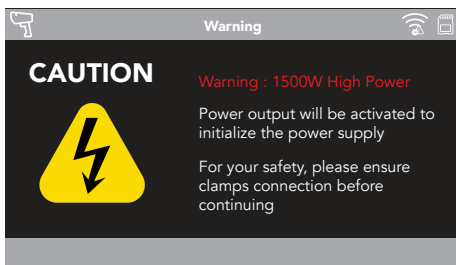

4 PRESS TO START

Click "✓" to start test.

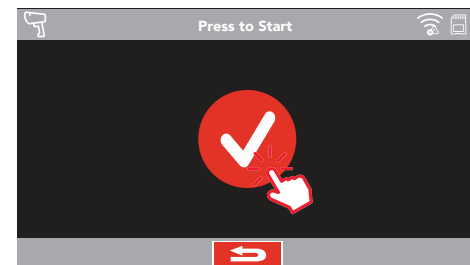

5 POWER SUPPLY

Power supply mode in charge. To stop the charge, press the stop button.

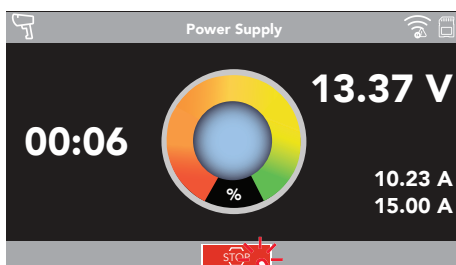

6 STOP CHARGING

Click "✓" to confirm the stop, Click "X" to go back to charging.

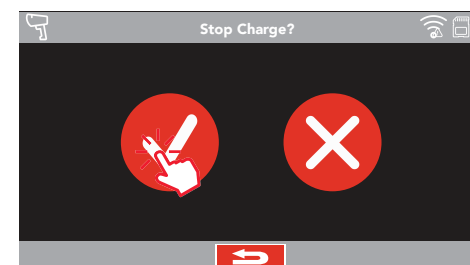

7 MAIN MENU

After stopping charge, it will go back to the Main Menu.



CONTACT US

TECH SUPPORT - USA
1-877-453-3265 English
support.usa@e-xteq.com

HOURS OF OPERATION (EST)
Monday - Friday: 8 am - 8 pm

Comprehensive support also available
through www.e-xteq.com